

Flange Head Fitting

Socket Weld Tube

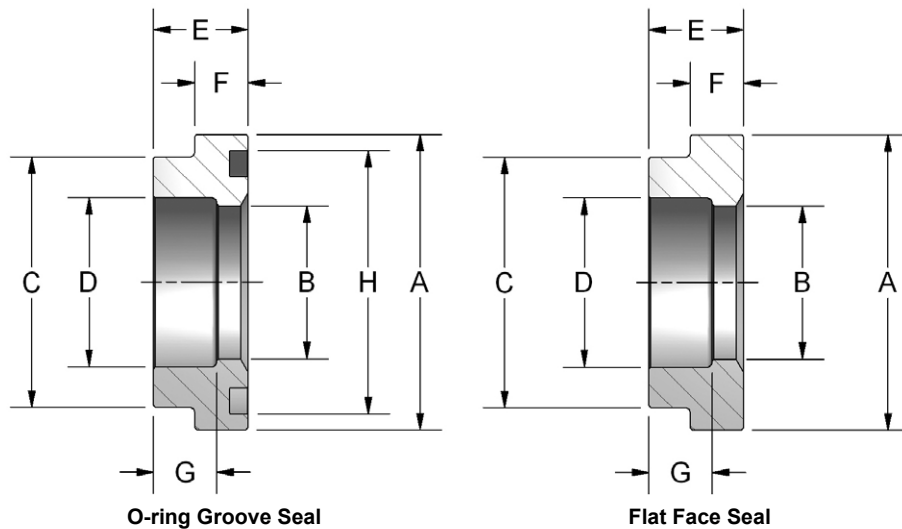

Ordering Information

FF	Flange Size	Material	Product Type	Seal	Rating Code	Tube Size	Port Type																																																																																
	<table border="1" style="width: 100%; border-collapse: collapse;"> <thead> <tr> <th colspan="2">Flange Size</th> </tr> </thead> <tbody> <tr> <td colspan="2">Rating code 1 only</td> </tr> <tr> <td style="text-align: center;">08</td> <td style="text-align: center;">0.50"</td> </tr> <tr> <td colspan="2">Rating code 1 or 2</td> </tr> <tr> <td style="text-align: center;">12</td> <td style="text-align: center;">0.75"</td> </tr> <tr> <td style="text-align: center;">16</td> <td style="text-align: center;">1.00"</td> </tr> <tr> <td style="text-align: center;">20</td> <td style="text-align: center;">1.25"</td> </tr> <tr> <td style="text-align: center;">24</td> <td style="text-align: center;">1.50"</td> </tr> <tr> <td style="text-align: center;">32</td> <td style="text-align: center;">2.00"</td> </tr> <tr> <td colspan="2">Rating code 1 only</td> </tr> <tr> <td style="text-align: center;">40</td> <td style="text-align: center;">2.50"</td> </tr> <tr> <td style="text-align: center;">48</td> <td style="text-align: center;">3.00"</td> </tr> </tbody> </table>	Flange Size		Rating code 1 only		08	0.50"	Rating code 1 or 2		12	0.75"	16	1.00"	20	1.25"	24	1.50"	32	2.00"	Rating code 1 only		40	2.50"	48	3.00"	<table border="1" style="width: 100%; border-collapse: collapse;"> <thead> <tr> <th colspan="2">Material</th> </tr> </thead> <tbody> <tr> <td style="text-align: center;">C</td> <td style="text-align: center;">Carbon Steel</td> </tr> </tbody> </table>	Material		C	Carbon Steel	<table border="1" style="width: 100%; border-collapse: collapse;"> <thead> <tr> <th colspan="2">Product Type</th> </tr> </thead> <tbody> <tr> <td style="text-align: center;">T</td> <td style="text-align: center;">Tube</td> </tr> </tbody> </table>	Product Type		T	Tube	<table border="1" style="width: 100%; border-collapse: collapse;"> <thead> <tr> <th colspan="2">Seal</th> </tr> </thead> <tbody> <tr> <td style="text-align: center;">G</td> <td style="text-align: center;">O-ring Groove</td> </tr> <tr> <td style="text-align: center;">F</td> <td style="text-align: center;">Flat Face</td> </tr> </tbody> </table>	Seal		G	O-ring Groove	F	Flat Face	<table border="1" style="width: 100%; border-collapse: collapse;"> <thead> <tr> <th colspan="2">Rating Code</th> </tr> </thead> <tbody> <tr> <td style="text-align: center;">1</td> <td>Code 61 • SAE J518 3.5 - 35 MPa • ISO 6162-1</td> </tr> <tr> <td style="text-align: center;">2</td> <td>Code 62 • SAE J518 40 MPa • ISO 6162-2</td> </tr> </tbody> </table>	Rating Code		1	Code 61 • SAE J518 3.5 - 35 MPa • ISO 6162-1	2	Code 62 • SAE J518 40 MPa • ISO 6162-2	<table border="1" style="width: 100%; border-collapse: collapse;"> <thead> <tr> <th colspan="4">Tube Size</th> </tr> </thead> <tbody> <tr> <td colspan="4" style="text-align: center; font-size: small;">Not all tube sizes are available for each flange size. See chart next page.</td> </tr> <tr> <td style="text-align: center;">08</td> <td style="text-align: center;">0.50"</td> <td style="text-align: center;">28</td> <td style="text-align: center;">1.75"</td> </tr> <tr> <td style="text-align: center;">10</td> <td style="text-align: center;">0.63"</td> <td style="text-align: center;">32</td> <td style="text-align: center;">2.00"</td> </tr> <tr> <td style="text-align: center;">12</td> <td style="text-align: center;">0.75"</td> <td style="text-align: center;">36</td> <td style="text-align: center;">2.25"</td> </tr> <tr> <td style="text-align: center;">16</td> <td style="text-align: center;">1.00"</td> <td style="text-align: center;">40</td> <td style="text-align: center;">2.50"</td> </tr> <tr> <td style="text-align: center;">20</td> <td style="text-align: center;">1.25"</td> <td style="text-align: center;">44</td> <td style="text-align: center;">2.75"</td> </tr> <tr> <td style="text-align: center;">24</td> <td style="text-align: center;">1.50"</td> <td style="text-align: center;">48</td> <td style="text-align: center;">3.00"</td> </tr> </tbody> </table>	Tube Size				Not all tube sizes are available for each flange size. See chart next page.				08	0.50"	28	1.75"	10	0.63"	32	2.00"	12	0.75"	36	2.25"	16	1.00"	40	2.50"	20	1.25"	44	2.75"	24	1.50"	48	3.00"	<table border="1" style="width: 100%; border-collapse: collapse;"> <thead> <tr> <th colspan="2">Port Type</th> </tr> </thead> <tbody> <tr> <td style="text-align: center;">E</td> <td style="text-align: center;">Tube Socket Weld</td> </tr> </tbody> </table>	Port Type		E	Tube Socket Weld
Flange Size																																																																																							
Rating code 1 only																																																																																							
08	0.50"																																																																																						
Rating code 1 or 2																																																																																							
12	0.75"																																																																																						
16	1.00"																																																																																						
20	1.25"																																																																																						
24	1.50"																																																																																						
32	2.00"																																																																																						
Rating code 1 only																																																																																							
40	2.50"																																																																																						
48	3.00"																																																																																						
Material																																																																																							
C	Carbon Steel																																																																																						
Product Type																																																																																							
T	Tube																																																																																						
Seal																																																																																							
G	O-ring Groove																																																																																						
F	Flat Face																																																																																						
Rating Code																																																																																							
1	Code 61 • SAE J518 3.5 - 35 MPa • ISO 6162-1																																																																																						
2	Code 62 • SAE J518 40 MPa • ISO 6162-2																																																																																						
Tube Size																																																																																							
Not all tube sizes are available for each flange size. See chart next page.																																																																																							
08	0.50"	28	1.75"																																																																																				
10	0.63"	32	2.00"																																																																																				
12	0.75"	36	2.25"																																																																																				
16	1.00"	40	2.50"																																																																																				
20	1.25"	44	2.75"																																																																																				
24	1.50"	48	3.00"																																																																																				
Port Type																																																																																							
E	Tube Socket Weld																																																																																						

Flange Head Fitting

Socket Weld Tube

CODE 61 TUBE FLANGE HEAD FITTING									
FLANGE SIZE	TUBE SIZE	A	B	C	D	E	F	G	H
0.50	0.50	1.188	.406	.924	.502	.50	.265	.312	1.000
0.50	0.63	1.188	.500	.924	.627	.50	.265	.312	1.000
0.75	0.75	1.500	.656	1.234	.752	.56	.265	.375	1.250
0.75	1.00	1.500	.750	1.234	1.002	.56	.265	.375	1.250
1.00	1.00	1.750	.906	1.484	1.002	.56	.315	.375	1.560
1.00	1.25	1.750	1.000	1.484	1.252	.56	.315	.375	1.560
1.25	1.25	2.000	1.125	1.684	1.252	.56	.315	.375	1.750
1.25	1.50	2.000	1.250	1.684	1.502	.56	.315	.375	1.750
1.50	1.50	2.375	1.375	1.964	1.502	.62	.315	.438	2.115
1.50	1.75	2.375	1.500	1.964	1.752	.62	.315	.438	2.115
2.00	2.00	2.812	1.875	2.434	2.002	.62	.375	.500	2.490
2.00	2.25	2.812	2.000	2.434	2.252	.62	.375	.500	2.490
2.50	2.50	3.312	2.375	2.904	2.502	.68	.375	.562	2.995
2.50	2.75	3.312	2.500	2.904	2.752	.68	.375	.500	2.995
3.00	3.00	4.000	2.875	3.534	3.002	.75	.375	.562	3.615

O-ring not included.

CODE 62 TUBE FLANGE HEAD FITTING									
FLANGE SIZE	TUBE SIZE	A	B	C	D	E	F	G	H
0.75	0.75	1.625	.656	1.234	.752	.69	.345	.500	1.250
0.75	1.00	1.625	.750	1.234	1.002	.69	.345	.500	1.250
1.00	1.00	1.875	.810	1.484	1.002	.81	.375	.625	1.560
1.00	1.25	1.875	1.000	1.484	1.252	.81	.375	.625	1.560
1.25	1.25	2.125	1.010	1.704	1.252	1.00	.405	.812	1.750
1.25	1.50	2.125	1.250	1.704	1.502	1.00	.405	.812	1.750
1.50	1.50	2.500	1.250	1.984	1.502	1.19	.495	1.000	2.115
1.50	1.75	2.500	1.500	1.984	1.757	1.19	.495	1.000	2.115
2.00	2.00	3.125	1.750	2.604	2.002	1.50	.495	1.375	2.490
2.00	2.25	3.125	2.000	2.604	2.252	1.50	.495	1.312	2.490

O-ring not included.

Pressure Ratings and Fastener Torque Values

CODE 61 SAE J518-1 / ISO 6162-1					
Dash Size	Inch Size	Max Working Pressure		Fastener Torque Value	
		PSI	MPa	Grade 8 UNC (lb-ft)	Grade 10.9 Metric (N-m)
-8	0.50"	5000	35.0	24	32
-12	0.75"	5000	35.0	44	70
-16	1.00"	4600	32.0	44	70
-20	1.25"	4000	28.0	68	70
-24	1.50"	3000	21.0	111	130
-32	2.00"	3000	21.0	111	130
-40	2.50"	2500	17.5	111	130
-48	3.00"	2300	16.0	218	295
-56	3.50"	500	3.5	218	295
-64	4.00"	500	3.5	218	295
-80	5.00"	500	3.5	218	295

CODE 62 SAE J518-2 / ISO 6162-2					
Dash Size	Inch Size	Max Working Pressure		Fastener Torque Value	
		PSI	MPa	Grade 8 UNC (lb-ft)	Grade 10.9 Metric (N-m)
-8	0.50"	6000	40.0	24	32
-12	0.75"	6000	40.0	44	70
-16	1.00"	6000	40.0	68	130
-20	1.25"	6000	40.0	111	130
-24	1.50"	6000	40.0	218	295
-32	2.00"	6000	40.0	332	550

Please note that all pressure ratings in this catalog refer to the flange connection. Adapting the flange to other connections, such as braze tube, welded pipe, or threaded ports / stud ends could reduce maximum working pressure.