

# Aluminum Flange Mount Bodies

## Flange Mount Body with 2-port Cavity

Flange interface seal is supplied. See chart.  
 Plug for GA Port (-6 SAE) is supplied.  
 (4) mounting bolts are user supplied and must pass through flange and valve body to thread into customers flange interface.

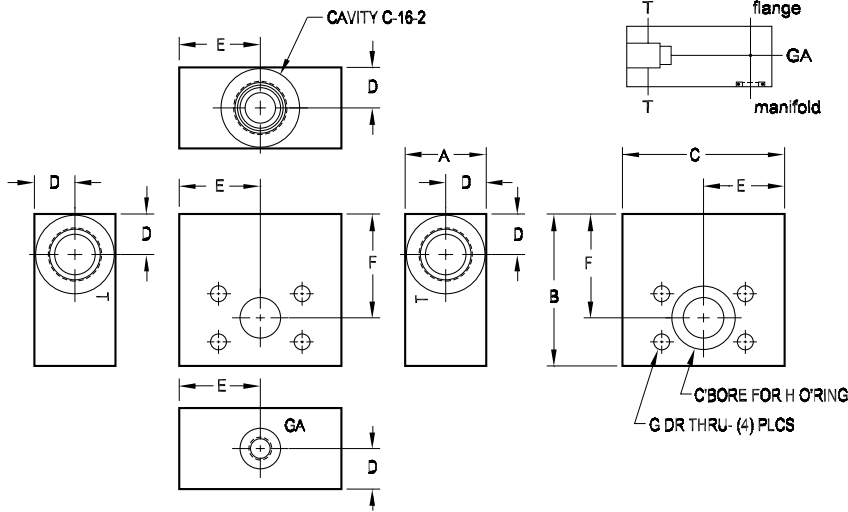

PART NO.	A	B	C	D
AFMBC16212F6116S	2.00 [50.8]	3.50 [88.9]	4.00 [101.6]	1.00 [25.4]
AFMBC16216F6116S	2.00 [50.8]	3.75 [95.3]	4.00 [101.6]	1.00 [25.4]
AFMBC16220F6116S	2.00 [50.8]	4.25 [108.0]	4.00 [101.6]	1.00 [25.4]
AFMBC16224F6116S	2.00 [50.8]	4.63 [117.5]	4.00 [101.6]	1.00 [25.4]

PART NO.	E	F	G	H
AFMBC16212F6116S	2.00 [50.8]	2.44 [61.9]	0.41 [10.3]	-214
AFMBC16216F6116S	2.00 [50.8]	2.56 [65.1]	0.41 [10.3]	-219
AFMBC16220F6116S	2.00 [50.8]	2.75 [69.9]	0.47 [11.9]	-222
AFMBC16224F6116S	2.00 [50.8]	2.88 [73.0]	0.53 [13.5]	-225

Specifications, descriptions, and dimensional data are subject to correction or change without notice or incurring obligation. Download latest catalog page revisions at [www.damanifolds.com](http://www.damanifolds.com).

## Ordering Information

Material	Product Type	Cavity Type	Cavity Size	Flange Size	Flange Rating	Port Threads																																				
<table border="1"> <tr><th colspan="2">Material</th></tr> <tr> <td><b>A</b></td> <td>Aluminum - 6061-T6 3000† psi • 20.7 MPa</td> </tr> <tr> <td colspan="2">† Working pressure should be considered in accordance with ISO 4413 to determine appropriate material type.</td> </tr> </table>	Material		<b>A</b>	Aluminum - 6061-T6 3000† psi • 20.7 MPa	† Working pressure should be considered in accordance with ISO 4413 to determine appropriate material type.		<table border="1"> <tr><th colspan="2">Product Type</th></tr> <tr> <td><b>FMB</b></td> <td>Flange Mount Body</td> </tr> </table>	Product Type		<b>FMB</b>	Flange Mount Body	<table border="1"> <tr><th colspan="2">Cavity Type</th></tr> <tr> <td><b>C</b></td> <td>Industry Standard Common Cavity</td> </tr> </table>	Cavity Type		<b>C</b>	Industry Standard Common Cavity	<table border="1"> <tr><th colspan="2">Cavity Size</th></tr> <tr> <td><b>162</b></td> <td>Cavity C-16-2</td> </tr> </table>	Cavity Size		<b>162</b>	Cavity C-16-2	<table border="1"> <tr><th colspan="2">Flange Size</th></tr> <tr> <td><b>12F</b></td> <td>ISO 6162 - DN19 Split Flange SAE Size 12 (0.75") Flange</td> </tr> <tr> <td><b>16F</b></td> <td>ISO 6162 - DN25 Split Flange SAE Size 16 (1.00") Flange</td> </tr> <tr> <td><b>20F</b></td> <td>ISO 6162 - DN32 Split Flange SAE Size 20 (1.25") Flange</td> </tr> <tr> <td><b>24F</b></td> <td>ISO 6162 - DN38 Split Flange SAE Size 24 (1.50") Flange</td> </tr> </table>	Flange Size		<b>12F</b>	ISO 6162 - DN19 Split Flange SAE Size 12 (0.75") Flange	<b>16F</b>	ISO 6162 - DN25 Split Flange SAE Size 16 (1.00") Flange	<b>20F</b>	ISO 6162 - DN32 Split Flange SAE Size 20 (1.25") Flange	<b>24F</b>	ISO 6162 - DN38 Split Flange SAE Size 24 (1.50") Flange	<table border="1"> <tr><th colspan="2">Flange Rating</th></tr> <tr> <td><b>61</b></td> <td>ISO 6162 - 2.5 to 35 MPa • SAE code 61</td> </tr> </table>	Flange Rating		<b>61</b>	ISO 6162 - 2.5 to 35 MPa • SAE code 61	<table border="1"> <tr><th colspan="2">Port Threads</th></tr> <tr> <td><b>16S</b></td> <td>-16 SAE "T" Ports -6 SAE "GA" Port ISO 11926; SAE 1926</td> </tr> </table>	Port Threads		<b>16S</b>	-16 SAE "T" Ports -6 SAE "GA" Port ISO 11926; SAE 1926
Material																																										
<b>A</b>	Aluminum - 6061-T6 3000† psi • 20.7 MPa																																									
† Working pressure should be considered in accordance with ISO 4413 to determine appropriate material type.																																										
Product Type																																										
<b>FMB</b>	Flange Mount Body																																									
Cavity Type																																										
<b>C</b>	Industry Standard Common Cavity																																									
Cavity Size																																										
<b>162</b>	Cavity C-16-2																																									
Flange Size																																										
<b>12F</b>	ISO 6162 - DN19 Split Flange SAE Size 12 (0.75") Flange																																									
<b>16F</b>	ISO 6162 - DN25 Split Flange SAE Size 16 (1.00") Flange																																									
<b>20F</b>	ISO 6162 - DN32 Split Flange SAE Size 20 (1.25") Flange																																									
<b>24F</b>	ISO 6162 - DN38 Split Flange SAE Size 24 (1.50") Flange																																									
Flange Rating																																										
<b>61</b>	ISO 6162 - 2.5 to 35 MPa • SAE code 61																																									
Port Threads																																										
<b>16S</b>	-16 SAE "T" Ports -6 SAE "GA" Port ISO 11926; SAE 1926																																									

# Ductile Iron Flange Mount Bodies

## Flange Mount Body with 2-port Cavity

Flange interface seal is supplied. See chart.  
 Plug for GA Port (-6 SAE) is supplied.  
 (4) mounting bolts are user supplied and must pass through flange and valve body to thread into customers flange interface.

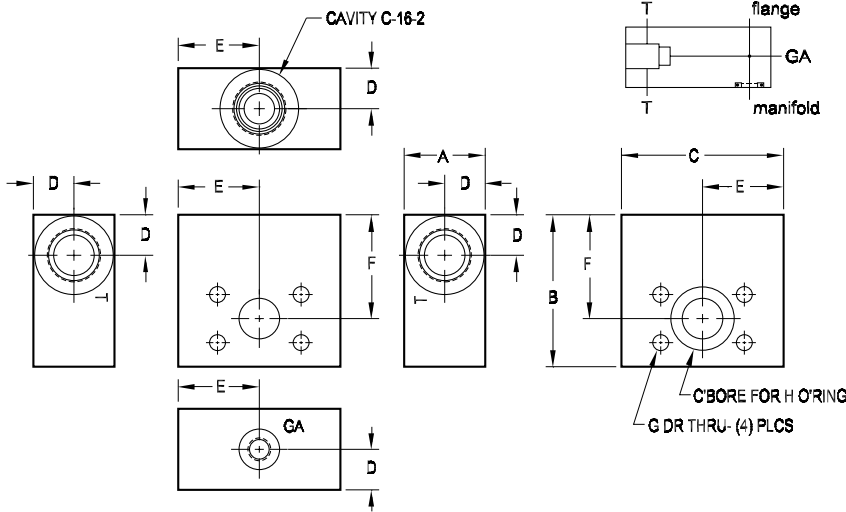

PART NO.	A	B	C	D
DFMBC16216F6216S	2.00 [50.8]	4.13 [104.8]	4.00 [101.6]	1.00 [25.4]
DFMBC16220F6216S	2.00 [50.8]	4.38 [111.1]	4.00 [101.6]	1.00 [25.4]
DFMBC16224F6216S	2.00 [50.8]	4.88 [123.8]	4.50 [114.3]	1.00 [25.4]

PART NO.	E	F	G	H
DFMBC16216F6216S	2.00 [50.8]	2.69 [68.3]	0.47 [11.9]	-219
DFMBC16220F6216S	2.00 [50.8]	2.81 [71.4]	0.53 [13.5]	-222
DFMBC16224F6216S	2.25 [57.2]	2.97 [75.4]	0.66 [16.7]	-225

Specifications, descriptions, and dimensional data are subject to correction or change without notice or incurring obligation.  
 Download latest catalog page revisions at [www.damanifolds.com](http://www.damanifolds.com).

## Ordering Information

Material	Product Type	Cavity Type	Cavity Size	Flange Size	Flange Rating	Port Threads																																		
<table border="1"> <tr><th colspan="2">Material</th></tr> <tr> <td><b>D</b></td> <td>Ductile Iron - D4512 5000† psi • 34.5 MPa</td> </tr> <tr> <td colspan="2">† Working pressure should be considered in accordance with ISO 4413 to determine appropriate material type.</td> </tr> </table>	Material		<b>D</b>	Ductile Iron - D4512 5000† psi • 34.5 MPa	† Working pressure should be considered in accordance with ISO 4413 to determine appropriate material type.		<table border="1"> <tr><th colspan="2">Product Type</th></tr> <tr> <td><b>FMB</b></td> <td>Flange Mount Body</td> </tr> </table>	Product Type		<b>FMB</b>	Flange Mount Body	<table border="1"> <tr><th colspan="2">Cavity Type</th></tr> <tr> <td><b>C</b></td> <td>Industry Standard Common Cavity</td> </tr> </table>	Cavity Type		<b>C</b>	Industry Standard Common Cavity	<table border="1"> <tr><th colspan="2">Cavity Size</th></tr> <tr> <td><b>162</b></td> <td>Cavity C-16-2</td> </tr> </table>	Cavity Size		<b>162</b>	Cavity C-16-2	<table border="1"> <tr><th colspan="2">Flange Size</th></tr> <tr> <td><b>16F</b></td> <td>ISO 6162 - DN25 Split Flange SAE Size 16 (1.00") Flange</td> </tr> <tr> <td><b>20F</b></td> <td>ISO 6162 - DN32 Split Flange SAE Size 20 (1.25") Flange</td> </tr> <tr> <td><b>24F</b></td> <td>ISO 6162 - DN38 Split Flange SAE Size 24 (1.50") Flange</td> </tr> </table>	Flange Size		<b>16F</b>	ISO 6162 - DN25 Split Flange SAE Size 16 (1.00") Flange	<b>20F</b>	ISO 6162 - DN32 Split Flange SAE Size 20 (1.25") Flange	<b>24F</b>	ISO 6162 - DN38 Split Flange SAE Size 24 (1.50") Flange	<table border="1"> <tr><th colspan="2">Flange Rating</th></tr> <tr> <td><b>62</b></td> <td>ISO 6162 -40 MPa • SAE code 62</td> </tr> </table>	Flange Rating		<b>62</b>	ISO 6162 -40 MPa • SAE code 62	<table border="1"> <tr><th colspan="2">Port Threads</th></tr> <tr> <td><b>16S</b></td> <td>-16 SAE "T" Ports -6 SAE "GA" Port ISO 11926; SAE 1926</td> </tr> </table>	Port Threads		<b>16S</b>	-16 SAE "T" Ports -6 SAE "GA" Port ISO 11926; SAE 1926
Material																																								
<b>D</b>	Ductile Iron - D4512 5000† psi • 34.5 MPa																																							
† Working pressure should be considered in accordance with ISO 4413 to determine appropriate material type.																																								
Product Type																																								
<b>FMB</b>	Flange Mount Body																																							
Cavity Type																																								
<b>C</b>	Industry Standard Common Cavity																																							
Cavity Size																																								
<b>162</b>	Cavity C-16-2																																							
Flange Size																																								
<b>16F</b>	ISO 6162 - DN25 Split Flange SAE Size 16 (1.00") Flange																																							
<b>20F</b>	ISO 6162 - DN32 Split Flange SAE Size 20 (1.25") Flange																																							
<b>24F</b>	ISO 6162 - DN38 Split Flange SAE Size 24 (1.50") Flange																																							
Flange Rating																																								
<b>62</b>	ISO 6162 -40 MPa • SAE code 62																																							
Port Threads																																								
<b>16S</b>	-16 SAE "T" Ports -6 SAE "GA" Port ISO 11926; SAE 1926																																							