

Mounting Bracket Riser Blocks

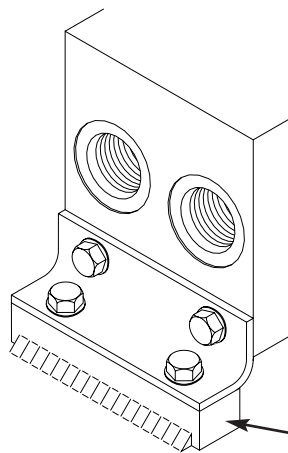

Riser block
Material mild steel
Weldable • uncoated

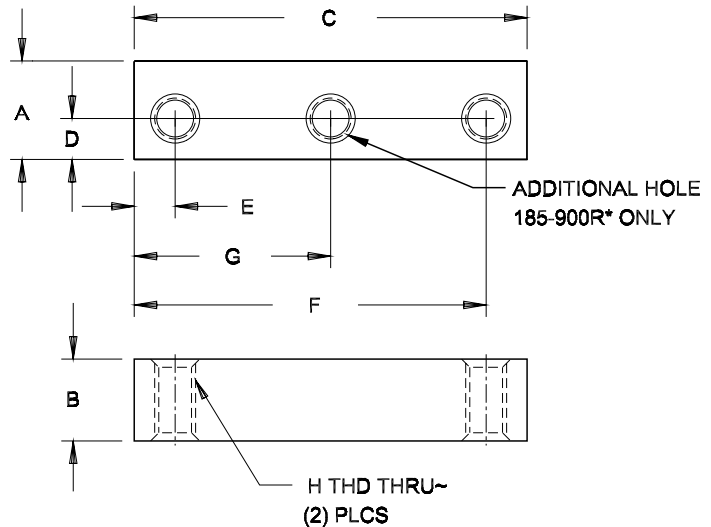

Part No.	A	B	C	D	E	F	G	H THD
185-250RU	0.63	0.50	2.50	0.25	0.25	2.25	--	0.250-20 UNC-2B
185-250RM	[16.0]	[12.7]	[63.5]	[6.4]	[6.4]	[57.2]	--	M6 x 1 ISO 6H
185-300RU	0.75	0.63	3.00	0.31	0.31	2.69	--	0.312-18 UNC-2B
185-300RM	[19.1]	[16.0]	[76.2]	[7.9]	[7.9]	[68.3]	--	M8 x 1.25 ISO 6H
185-350RU	0.75	0.63	3.50	0.31	0.56	2.94	--	0.312-18 UNC-2B
185-350RM	[19.1]	[16.0]	[88.9]	[7.9]	[14.2]	[74.6]	--	M8 x 1.25 ISO 6H
185-400RU	0.75	0.63	4.00	0.31	0.31	3.69	--	0.312-18 UNC-2B
185-400RM	[19.1]	[16.0]	[101.6]	[7.9]	[7.9]	[93.7]	--	M8 x 1.25 ISO 6H
185-500RU	1.00	0.75	5.00	0.44	0.44	4.56	--	0.375-16 UNC-2B
185-500RM	[25.4]	[19.1]	[127.0]	[11.2]	[11.2]	[115.9]	--	M10 x 1.5 ISO 6H

Part No.	A	B	C	D	E	F	G	H THD
185-600RU	1.25	1.00	6.00	0.56	0.56	5.44	--	0.500-13 UNC-2B
185-600RM	[31.8]	[25.4]	[152.4]	[14.2]	[14.2]	[138.1]	--	M12 x 1.75 ISO 6H
185-700RU	1.25	1.00	7.00	0.56	0.69	6.31	--	0.500-13 UNC-2B
185-700RM	[31.8]	[25.4]	[177.8]	[14.2]	[17.5]	[160.3]	--	M12 x 1.75 ISO 6H
185-800RU	1.25	1.00	8.00	0.56	1.19	6.81	--	0.500-13 UNC-2B
185-800RM	[31.8]	[25.4]	[203.2]	[14.2]	[30.2]	[173.0]	--	M12 x 1.75 ISO 6H
185-900RU	1.25	1.00	9.00	0.56	0.69	8.31	4.50	0.500-13 UNC-2B
185-900RM	[31.8]	[25.4]	[228.6]	[14.2]	[17.5]	[211.1]	[114.3]	M12 x 1.75 ISO 6H

Specifications, descriptions, and dimensional data are subject to correction or change without notice or incurring obligation. Download latest catalog page revisions at www.damanifolds.com.

Ordering Information

